

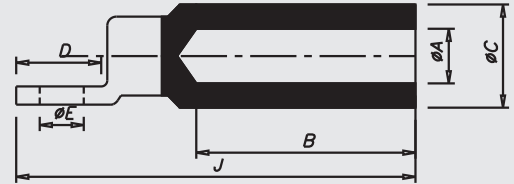

## ALUMINUM-COPPER BI-METAL TERMINAL WITH COPPER PALMS

Aluminium Barrel, Copper Palm  
Final Metal State : Fully Annealed,  
Including Joint.  
Joining method friction welding



Size mm <sup>2</sup>	A	C	D	E	J	B	MG CAT NO.	Crimping Tools Code
16	5.5	16	20	10.3	79	43	MGBT 16-10	MG-70H
25	6.5	16	20	10.3	79	43	MGBT 25-10	MG-70H
35	8	16	20	10.3	79	43	MGBT 35-10	MG-70H
50	9	20	25	12.8	85	43	MGBT 50-12	MG-120H
70	11	20	25	12.8	85	43	MGBT 70-12	MG-120H
95	12.5	20	25	12.8	85	43	MGBT 95-12	MG-120H
120	13.7	25	30	12.8	108	59	MGBT 120-12	MG-300H
150	15.5	25	30	12.8	108	59	MGBT 150-12	MG-300H
185	17	32	35	14.5	115	59	MGBT 185-14	MG-300H
240	19.5	32	35	14.5	115	59	MGBT 240-14	MG-300H
300	23.3	40	36	16.5	137	85	MGBT 300-16	MG-1000
400	26	40	36	16.5	153.5	85	MGBT 400-16	MG-1000
500	29.1	47	60X60	-	196	95	MGBT 500	MG-1000
630	33.5	47	60X60	-	196	95	MGBT 630	MG-1000
800	37.5	53	80X80	-	232	100	MGBT 800	MG-1000
1000	42	60	80X80	-	256	126	MGBT 1000	MG-1000

\*All dimensions in mm

WE CONNECT ENERGY

[www.mgelectrica.com](http://www.mgelectrica.com)

F-41, MIDC Area, Satpur, Nasik-7, Maharashtra, India. Telfax: +91 253 2350961, 2350163 lugs@mgelectrica.com

**For details about our other products and specifications please refer the corporate website**

Disclaimer: M.G reserve the right product without prior, as part of its continual improvement programme. Whilst every effort is taken to ensure the accuracy of information contained in the sheet, M.G accepts no liability for matters arising as result of errors or omissions.