

## COPPER IN-LINE CONNECTOR AS PER BS-4579

MATERIAL : COPPER BS 1977:1976  
& IS 1897  
SURFACE: TIN PLATED

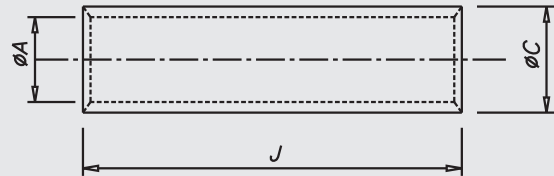

Size mm <sup>2</sup>	A	C	J	MG CAT NO.	Crimping Tools Code
1.5	1.8	3.7	15	MGBC-1.5	MG-10
2.5	2.4	4	18	MGBC-2.5	MG-10
4	3.1	4.8	19	MGBC-4	MG-10
6	3.8	5.5	20	MGBC-6	MG-10
10	4.5	6.2	23	MGBC-10	MG-10
16	5.4	7.1	25	MGBC-16	MG-50BS
25	6.8	9.8	35	MGBC-25	MG-50BS
35	8.2	10.6	38	MGBC-35	MG-50BS
50	9.5	12.4	42	MGBC-50	MG-50BS
70	11.2	14.7	47	MGBC-70	MG-120H
95	13.5	17.4	47	MGBC-95	MG-120H
120	15	19.4	65	MGBC-120	MG-120H
150	16.5	21.2	65	MGBC-150	MG-300H
185	18.5	23.5	67	MGBC-185	MG-300H
240	21	26.5	80	MGBC-240	MG-300H
300	23.5	30	89	MGBC-300	MG-300H
400	26.8	34.8	100	MGBC-400	MG-1000
500	30	39	115	MGBC-500	MG-1000
630	35	45	115	MGBC-630	MG-1000
800	39	50.6	230	MGBC-800	MG-1000
1000	43	56.2	230	MGBC-1000	MG-1000

\*All dimensions in mm

WE CONNECT ENERGY

[www.mgelectrica.com](http://www.mgelectrica.com)

F-41, MIDC Area, Satpur, Nasik-7, Maharashtra, India. Telfax: +91 253 2350961, 2350163 lugs@mgelectrica.com

For details about our other products and specifications please refer the corporate website

Disclaimer: M.G reserve the right product without prior, as part of its continual improvement programme. Whilst every effort is taken to ensure the accuracy of information contained in the sheet, M.G accepts no liability for matters arising as result of errors or omissions.