

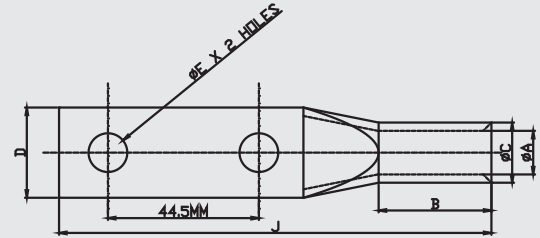

COPPER TWO HOLE EXTENDED PALM TERMINALS

MATERIAL : COPPER BS 1977:1976
& IS 1897
SURFACE: TIN PLATED



Size mm ²	E	A	C	D	B	J	MG CAT NO.	Crimping Tools Code
16	10.5	5.4	7.6	14.5	16	100	MGTT-16-10	MG-50BS
25	10.5	6.8	8.8	15	16	100	MGTT-25-10	MG-50BS
35	10.5	8.2	10.6	16.5	16	100	MGTT-35-10	MG-50BS
50	10.5	9.5	12.4	17	25	109	MGTT-50-10	MG-50BS
50	13	9.5	12.4	17	25	109	MGTT-50-13	MG-50BS
70	10.5	11.3	14.7	21	30	114	MGTT-70-10	MG-70H
70	13	11.3	14.7	21	30	114	MGTT-70-13	MG-70H
95	10.5	13.5	17.4	25	30	116	MGTT-95-10	MG-120H
95	13	13.5	17.4	25	30	116	MGTT-95-13	MG-120H
120	10.5	15	19.4	27.5	35	122	MGTT-120-10	MG-120H
120	13	15	19.4	27.5	35	122	MGTT-120-13	MG-120H
150	10.5	16.5	21.2	30	40	126	MGTT-150-10	MG-300H
150	13	16.5	21.2	30	40	126	MGTT-150-13	MG-300H
185	10.5	18.5	23.5	33.5	42	132	MGTT-185-10	MG-300H
185	13	18.5	23.5	33.5	42	132	MGTT-185-13	MG-300H
240	10.5	21	26.5	38.5	50	143	MGTT-240-10	MG-300H
240	13	21	26.5	38.5	50	143	MGTT-240-13	MG-300H
300	13.7	23.5	30	43	55	144	MGTT-300-13	MG-300H
400	13.7	28.5	36.5	52.5	60	149	MGTT-400-13	MG-1000
500	13.7	30	39	56	65	160	MGTT-500-13	MG-1000
630	13.7	35	45	58	75	160	MGTT-630-13	MG-1000

*All dimensions in mm

WE CONNECT ENERGY

www.mgelectrica.com

F-41, MIDC Area, Satpur, Nasik-7, Maharashtra, India. Telfax: +91 253 2350961, 2350163 lugs@mgelectrica.com

For details about our other products and specifications please refer the corporate website

Disclaimer: M.G reserve the right product without prior, as part of its continual improvement programme. Whilst every effort is taken to ensure the accuracy of information contained in the sheet, M.G accepts no liability for matters arising as result of errors or omissions.