

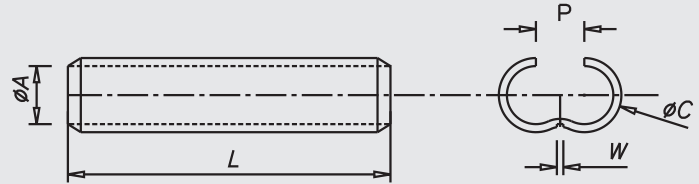

COPPER WEAK BACK FERRULE

MATERIAL : COPPER BS 1977:1976
& IS 1897
SURFACE: TIN PLATED



Cable Size mm ²	A	C	G	L	T	P	W	MG CAT NO.	Crimping Tools Code
6	3	4.6	2	20	0.8	3	-	MGWB-6	
10	4.4	6	2	25	0.8	4	-	MGWB-10	
16	5.5	7.5	2	25	1	5	1.5	MGWB-16	
25	7	9	2	30	1	7	1.5	MGWB-25	
35	8	10.4	2	35	1.2	8	1.5	MGWB-35	
50	9.5	11.9	2	40	1.2	9	1.5	MGWB-50	
70	12	14.8	3	45	1.4	12	3	MGWB-70	
95	13.5	16.3	3	50	1.4	13	3	MGWB-95	
120	15.5	18.7	4	55	1.6	15	3	MGWB-120	
150	17	20.6	4	60	1.8	16	3	MGWB-150	
185	18.5	22.9	4	65	2.2	18	5	MGWB-185	
225	20.5	24.9	5	75	2.2	20	5	MGWB-225	
240	22	26.4	5	80	2.2	21	5	MGWB-240	
300	24	29.6	5	85	2.8	23	5	MGWB-300	
400	28.5	34.7	7	95	3.1	27	5	MGWB-400	
500	30.5	37.5	7	105	3.5	30	5	MGWB-500	
630	34.5	42.5	8	115	4	33	5	MGWB-630	

*All dimensions in mm

WE CONNECT ENERGY

www.mgelectrica.com

F-41, MIDC Area, Satpur, Nasik-7, Maharashtra, India. Telfax: +91 253 2350961, 2350163 lugs@mgelectrica.com

For details about our other products and specifications please refer the corporate website

Disclaimer: M.G reserve the right product without prior, as part of its continual improvement programme. Whilst every effort is taken to ensure the accuracy of information contained in the sheet, M.G accepts no liability for matters arising as result of errors or omissions.